



## Remembrance Poppy

The red poppy, which became a national emblem of remembrance in 1920, is worn to honor and memorialize those who gave their lives to protect our country's freedom. It's historical roots date back to World War I, when a Lieutenant Colonel was overcome with sorrow after a battle in the poppy-covered Flanders Field in Belgium. The Colonel wrote a poem to channel his grief, called "In Flanders Fields".

This poem caught the eye of a professor at the University of Georgia, and she vowed to always wear a red poppy in remembrance of those who had been left behind. She lobbied to make the red poppy a national memorial symbol, and on September 27, 1920, the red poppy officially became the U.S. national emblem of remembrance.



Red poppies are donned on Memorial Day and also on National Poppy Day. The American Legion Auxiliary - female relatives of wartime veterans, is the main group that raises money through the distribution of crepe-paper poppies. These poppies are handcrafted by veterans and provides them wages and a therapeutic outlet.





## Legend

- ① Seven stainless steel monuments with engraved names
- ② Unit motto etched into concrete
- ③ Painted steel 'slice' of poppy image
- ④ Bench (changed to curved wood & metal)
- ⑤ Decorative paving
- ⑥ Flush-mount lights to illuminate names

## Materials

- Stainless steel
- Painted steel
- Etched concrete

When viewed from one specific point, the seven monuments unite to form a single image.



Elevation from lawn

# Remembrance Poppy

DESIGN CONCEPT



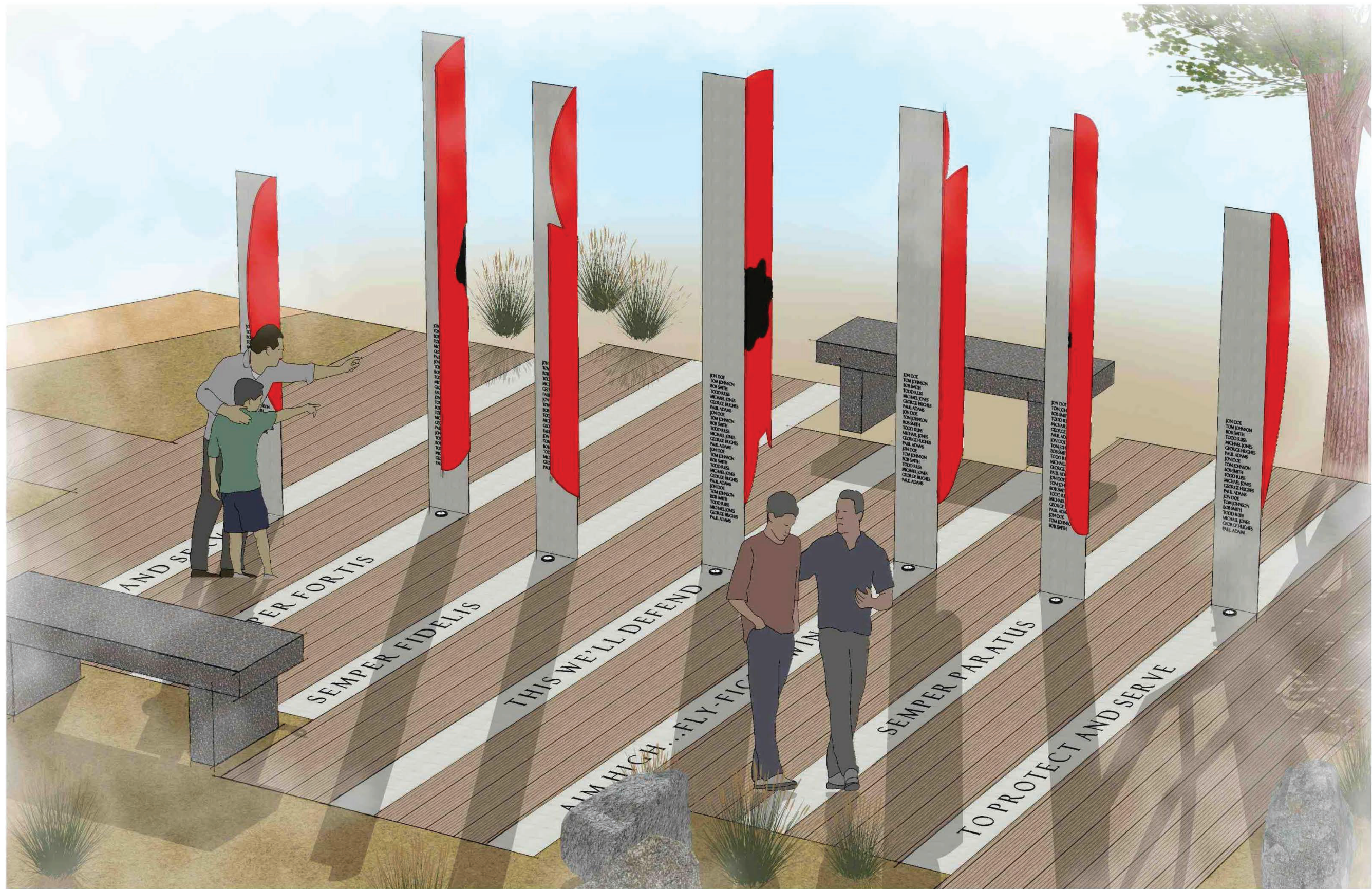

# Remembrance Poppy

DESIGN CONCEPT



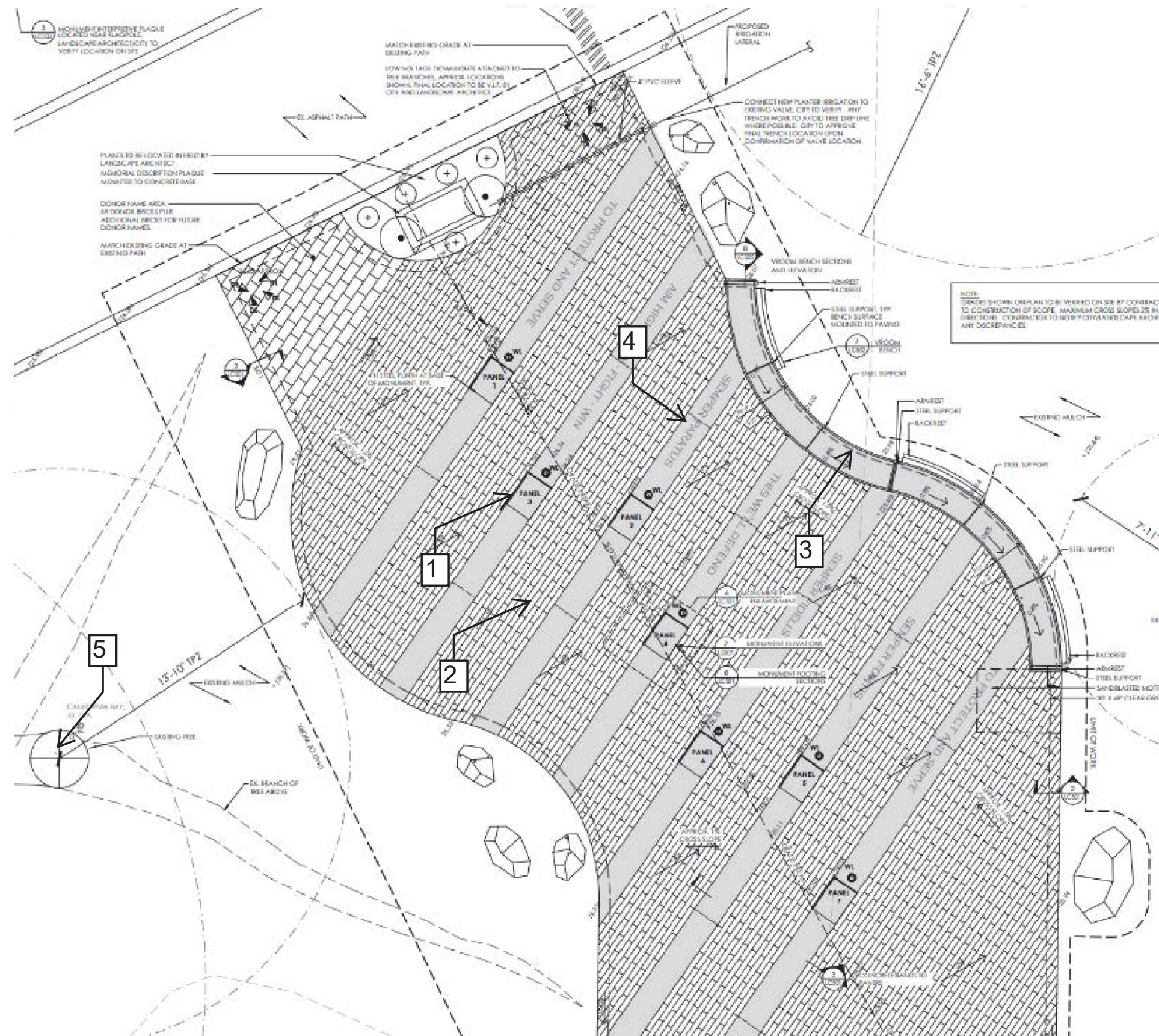

# Legend

- ① Seven steel monuments with engraved names
- ② Decorative paving
- ③ Bench
- ④ Mottos etched in concrete
- ⑤ Existing tree

## Remembrance Poppy

PLAN VIEW

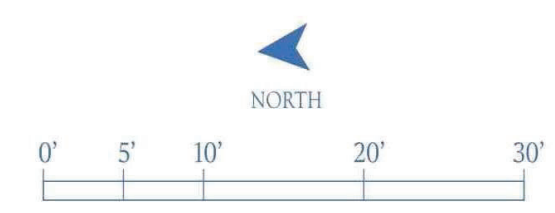



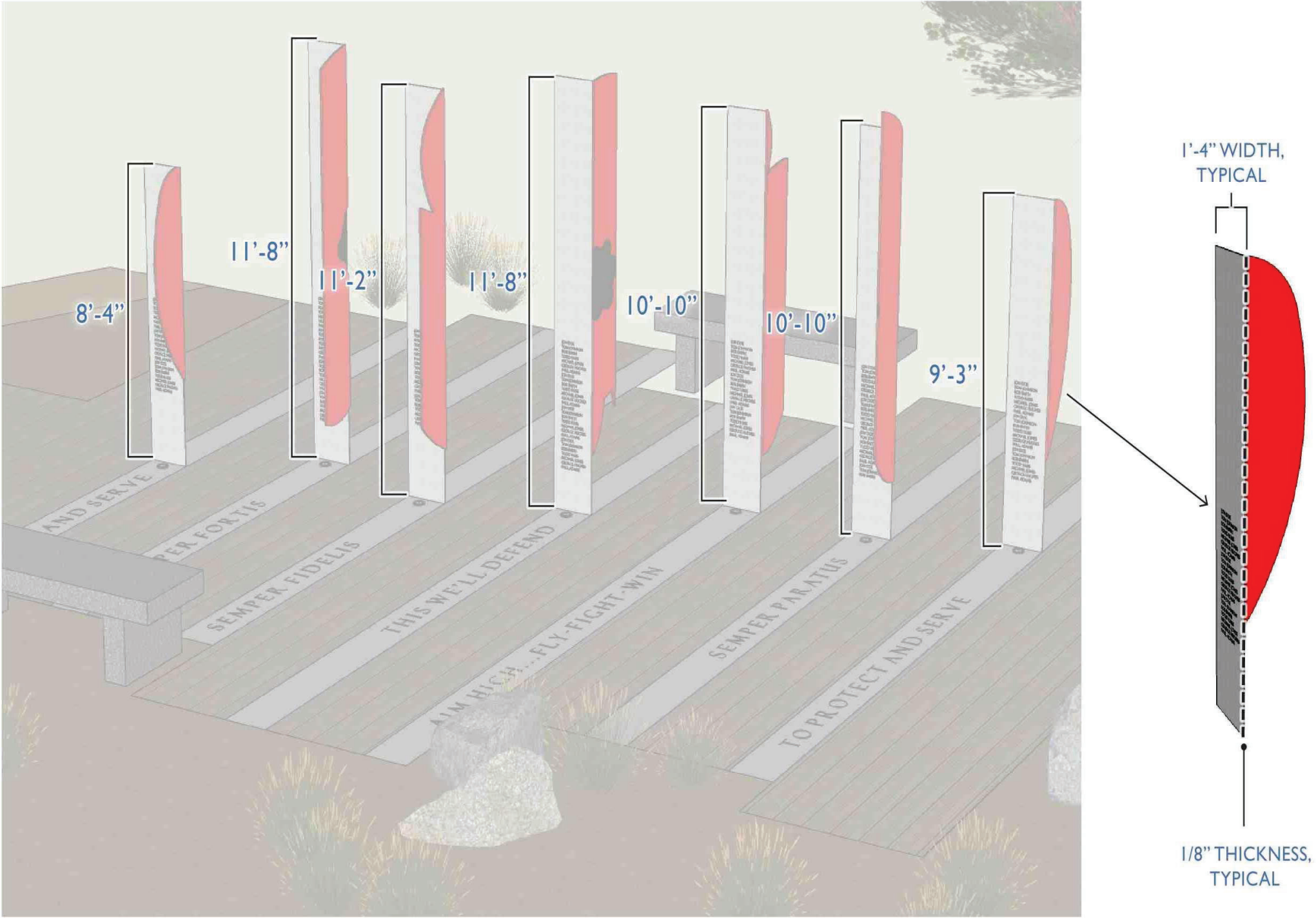

**FALLEN HEROES MEMORIAL**  
MONUMENT DIMENSIONS  
SAN MATEO, CA

AUGUST 5TH, 2020





STAINLESS STEEL (ENGRAVED)\*



STAINLESS STEEL (PAINTED)



BENCH

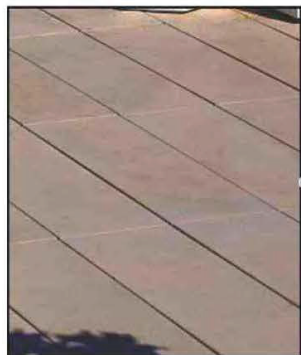

LINEAR PAVERS

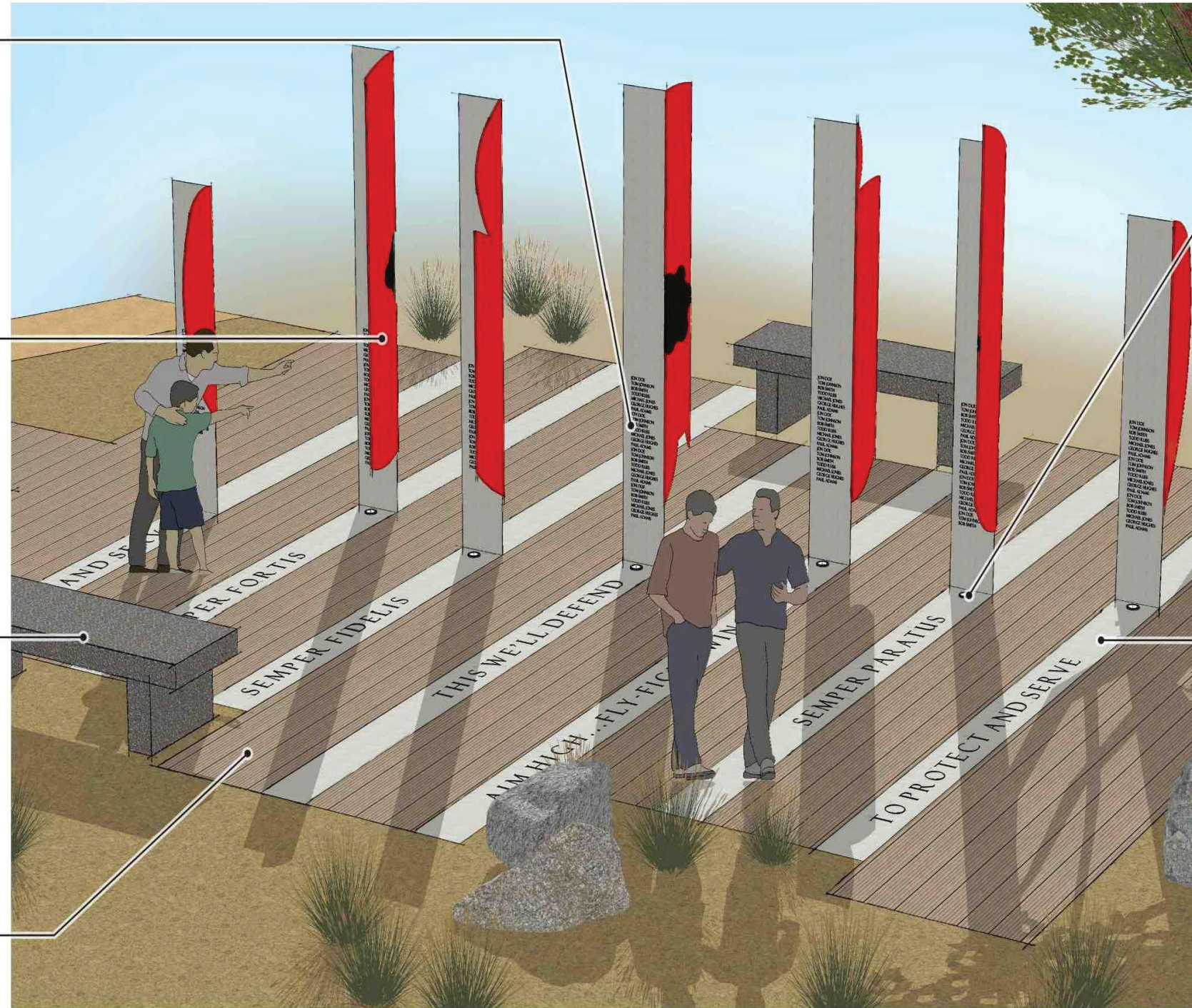

IN-GROUND LIGHTING

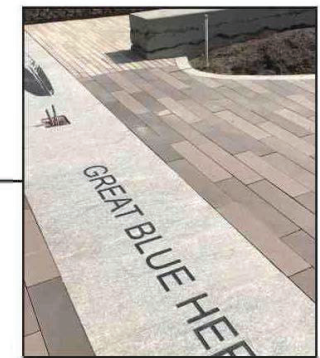

OPTION A:  
ENGRAVED CONCRETE\*

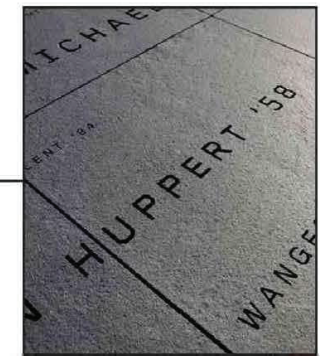

OPTION B:  
ENGRAVED GRANITE

\*PHOTO CREDIT:  
LA JOLLA ETCHING

# FALLEN HEROES MEMORIAL

MATERIALS

SAN MATEO, CA

AUGUST 5TH, 2020